

4. **HIWIN LAS Series (1)**

LAS-1 /-2



Screw type	ACME
Weight*	0.86 kg
Protection	IP 54
Compatible controller	LAK2

*Stroke length 200mm

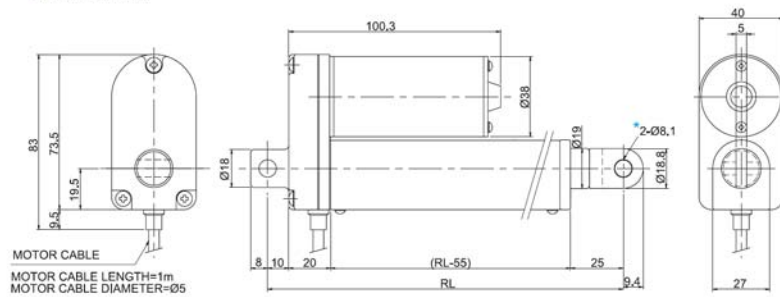

- $RL = S + 119$
 RL : Retracted length
 S : Stroke length

Note: Piston rod eye, marked with *, can be rotated 180° counterclockwise to adjust the orientation of the hole of the front end.